

WEST SUSSEX COUNTY COUNCIL  
((CRAWLEY BOROUGH)(PARKING PLACES AND TRAFFIC REGULATION)  
(CONSOLIDATION) ORDER 2010)  
(MANOR ROYAL AMENDMENT)  
ORDER 2022

CRAWLEY: LOCATION OF WAITING RESTRICTIONS

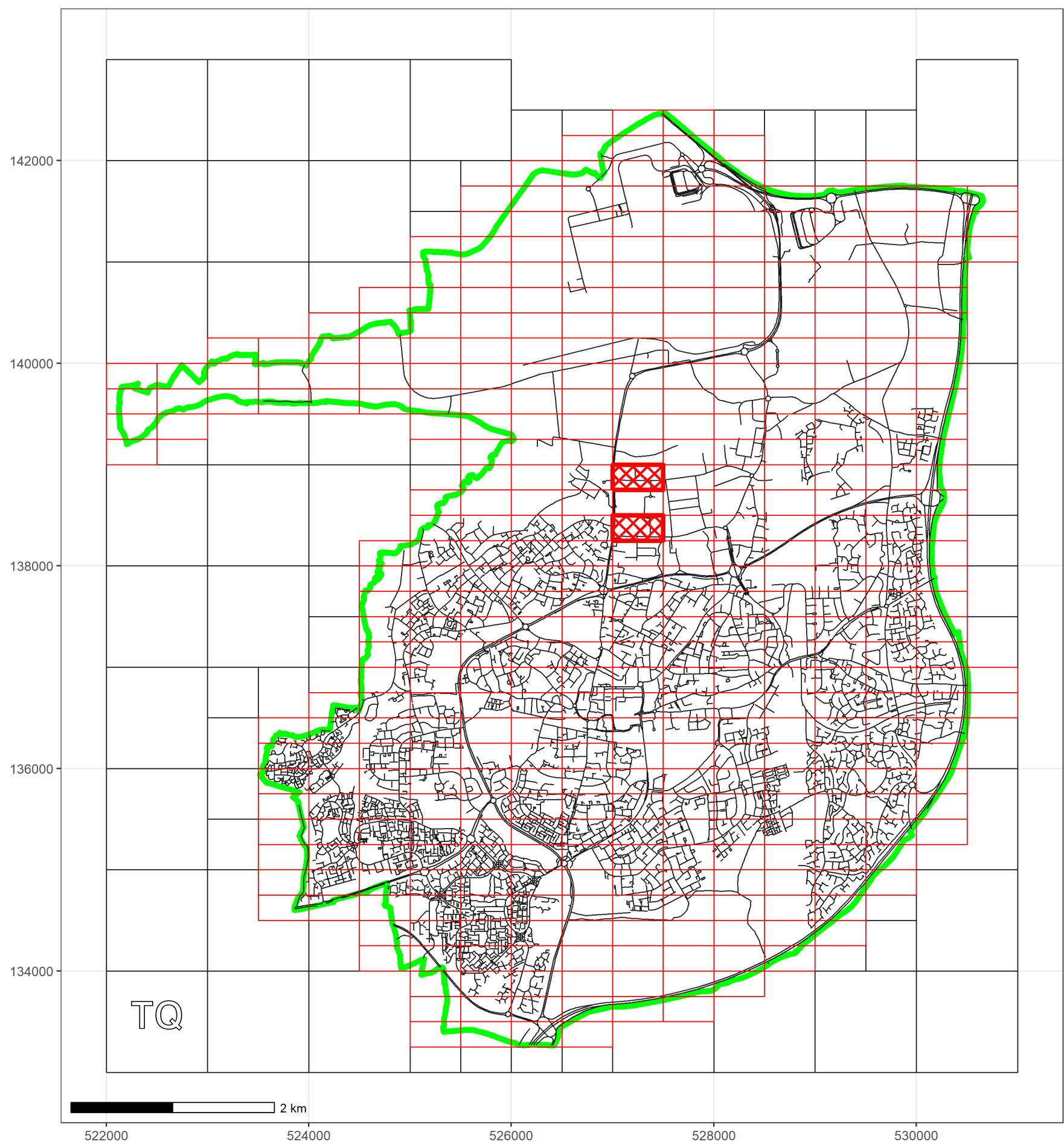

**KEY:**

OS.TILE GRID

PARKING TILE GRID

LOCATION OF WAITING RESTRICTIONS

PARISH BOUNDARY

ROAD NETWORK

CONTROLLED PARKING ZONE BOUNDARY



West Sussex County Council  
Highways & Transport  
The Grange  
Tower Street  
Chichester  
West Sussex  
PO19 1RH

WEST SUSSEX COUNTY COUNCIL  
((CRAWLEY BOROUGH)(PARKING PLACES AND TRAFFIC  
REGULATION)(CONSOLIDATION) ORDER 2010)  
(MANOR ROYAL AMENDMENT)  
ORDER 2022

LOCATION OF WAITING RESTRICTIONS



Key for Waiting Restrictions

All areas over which the provision of the orders apply are defined by the shaded areas as shown on the following plans plus a contiguous area not indicated on the plans of verge and/or footway between the carriageway edge and the highway boundary. The plans in this schedule are based upon grid references of the Ordnance Survey National Grid defined by the OSGB 36 triangulation.

Prohibition of Waiting

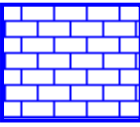
101		check	No waiting at any time
103		brick 1	No waiting 7.00am-7.00pm any day

**WEST SUSSEX COUNTY COUNCIL**  
**((CRAWLEY BOROUGH) (PARKING PLACES AND TRAFFIC REGULATION)**  
**(CONSOLIDATION) ORDER 2010)**  
**(MANOR ROYAL AMENDMENT) ORDER 2022**

West Sussex County Council in exercise of their powers under Sections 1 (1) 2 (1) and (2), 4 (2), 45, 46, 49 and 53 and Part IV of Schedule 9 of the Road Traffic Regulation Act 1984 "the Act" as amended and of all other enabling powers and after consultation with the chief officer of police in accordance with Part III of Schedule 9 to the Act hereby make the following Order:-

1. This Order shall come into operation on the 14<sup>th</sup> day of November 2022 and may be cited as "West Sussex County Council ((Crawley Borough) (Parking Places and Traffic Regulation) (Consolidation) Order 2010) (Manor Royal Amendment) Order 2022."
2. The "West Sussex County Council (Crawley Borough) (Parking Places and Traffic Regulation) (Consolidation) Order 2010" is hereby amended by the deletion from it of the plans specified in the First Schedule to this Order and the substitution of the plans attached in the Second Schedule to this Order.

**FIRST SCHEDULE**  
**Plans to be deleted**

TQ2738NWN (Sheet Issue No. 1)  
TQ2738SWN (Sheet Issue No. 1)

**SECOND SCHEDULE**  
**Plans to be substituted**  
**(as attached)**

TQ2738NWN (Sheet Issue No. 2)  
TQ2738SWN (Sheet Issue No. 2)

**For and on behalf of WEST SUSSEX COUNTY COUNCIL**

Authorised Signatory:



NAME: Rebecca Caney

DATE MADE: 8<sup>th</sup> November 2022

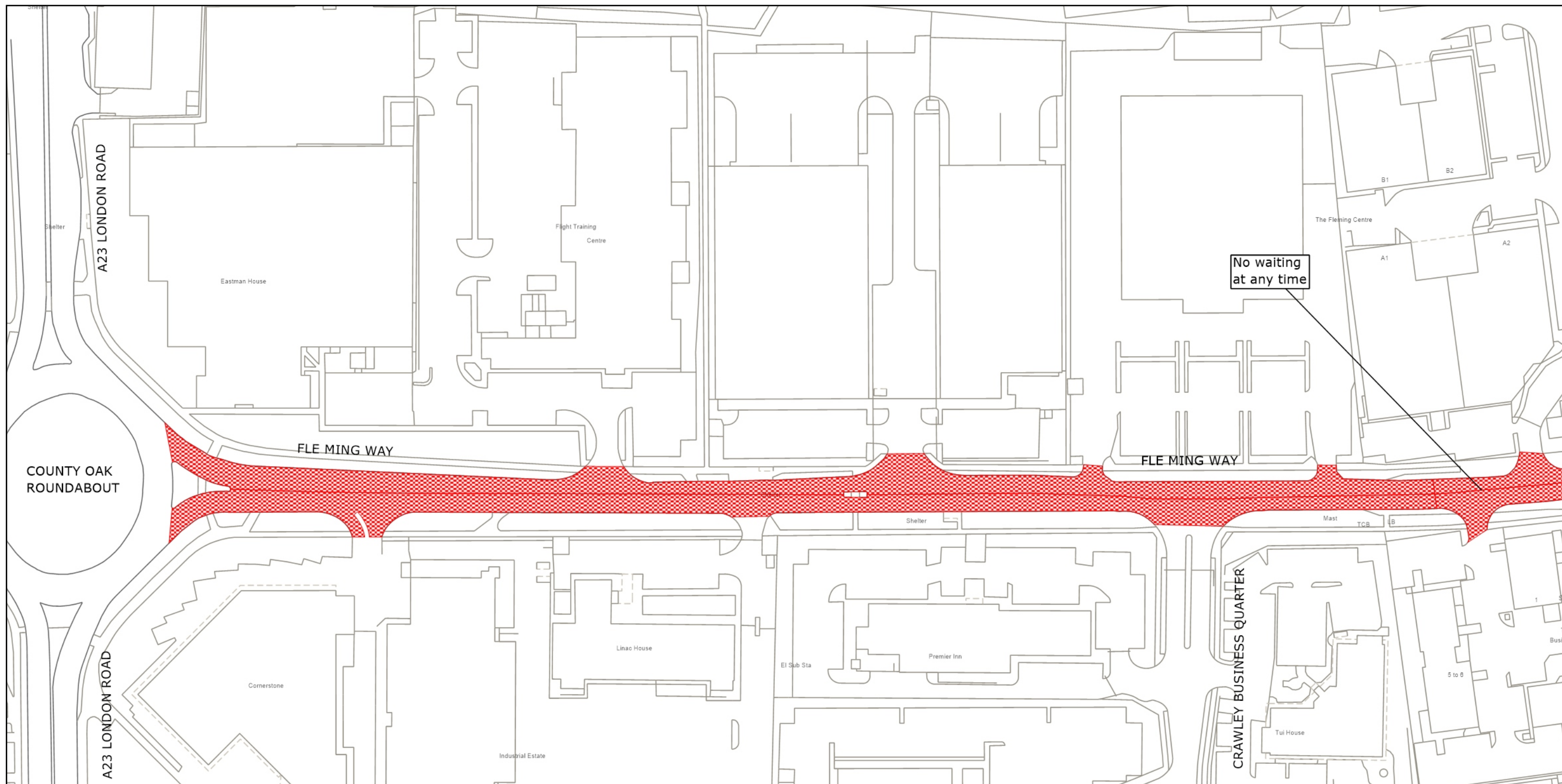

West Sussex County Council  
Highways & Transport  
The Grange  
Tower Street  
Chichester  
West Sussex  
PO19 1RH

CRAWLEY BOROUGH: LANGLEY GREEN & TUSHMORE WARD

WAITING RESTRICTIONS

Reproduced from or based upon 2022 Ordnance Survey mapping with permission of the Controller of HMSO (c) Crown Copyright reserved.  
Unauthorised reproduction infringes Crown copyright and may lead to prosecution or civil proceedings West Sussex County Council Licence No. 100018485

TILE REF NO:  
**TQ2738NWN**

SHEET ISSUE NO 2  
SHEET ACTIVE FROM - 14.11.2022



SCALE:  
1:1250  
at A3 size



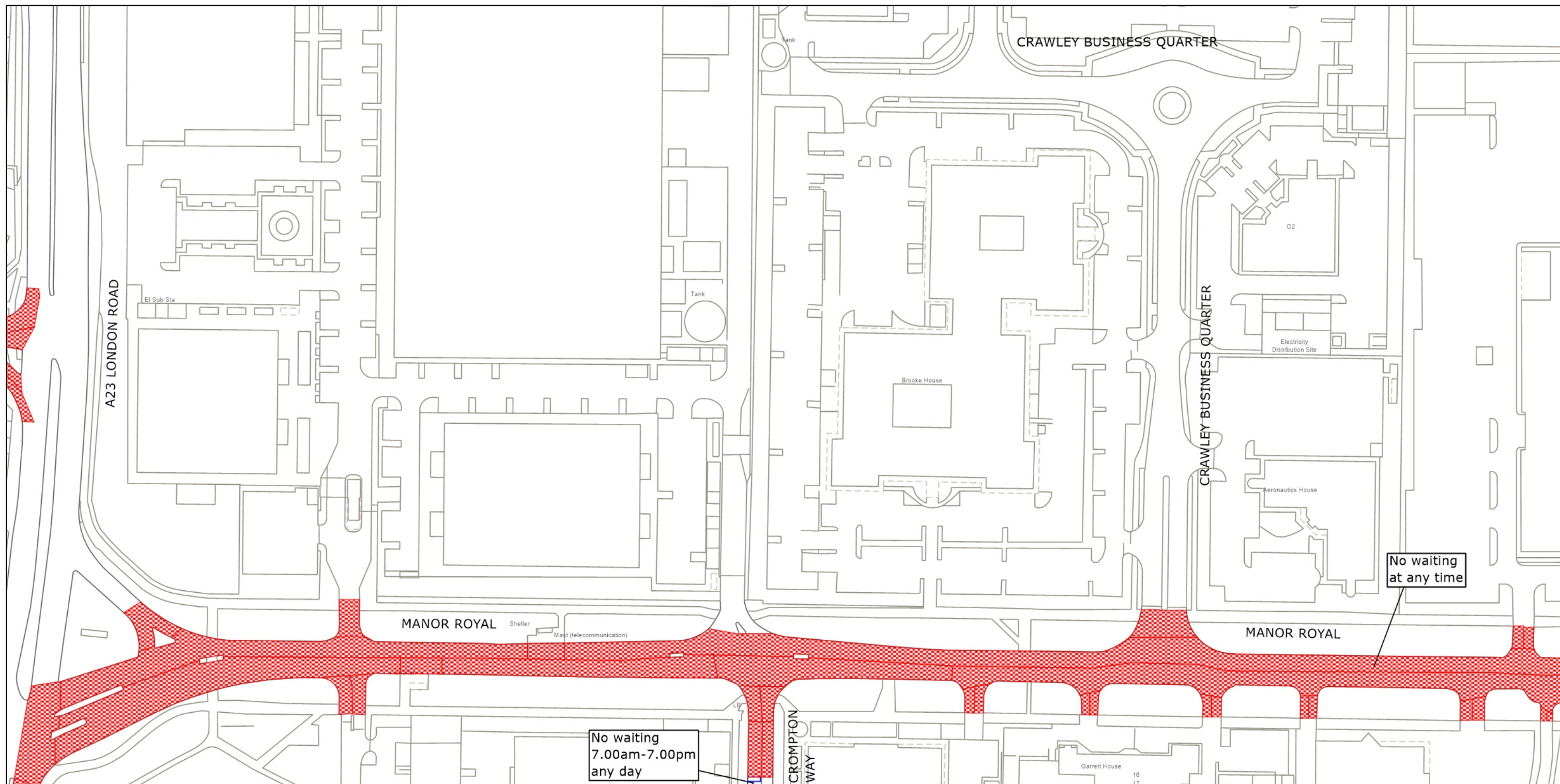

West Sussex County Council  
Highways & Transport  
The Grange  
Tower Street  
Chichester  
West Sussex  
PO19 1RH

CRAWLEY BOROUGH: LANGLEY GREEN & TUSHMORE WARD  
WAITING RESTRICTIONS

Reproduced from or based upon 2022 Ordnance Survey mapping with permission of the Controller of HMSO (c) Crown Copyright reserved.  
Unauthorised reproduction infringes Crown copyright and may lead to prosecution or civil proceedings West Sussex County Council Licence No. 100018485

TILE REF NO:  
TQ2738SWN

SHEET ISSUE NO 2  
SHEET ACTIVE FROM - 14.11.2022

N  
SCALE:  
1:1250  
at A3 size